

PROPERTY AND SURVEY BRANCH
DEPARTMENT OF THE INTERIOR.

JEM.HG

T.L.5905
No. T.L.1433
T.L.1435

12 SEP 1950

PROPOSED BOTANICAL GARDENS - CANBERRA.

The Surveyor General:

Reference is made to the area reserved for botanical gardens which is indicated by firm brown line on Plan Ms 431 attached.

Request has been made by Superintendent of Parks and Gardens that about 266 acres of the area be made available for immediate treatment, and in order to protect tree planting carried out, for the area to be enclosed by rearrangement and erection of fencing necessary.

The subject area of approximately 266 acres comprises portions from different rural leases in the Canberra City District which are shown in colour on plan Ms 431, particulars being as follow:-

Block	Area	Tenure	Lessee	Proposed Withdrawal	Colour.
Ms 338 1	115½	Quarterly	Kaye	13 acres.	Yellow
431 4	391	"	Corkhill	164 "	Pink
321 12	139½	1958	Kaye	4 "	Blue
63	137	P.O.	C.S.I.R.O.	85 "	Green

The subject areas are used mainly for grazing purposes, with the exception of Block 63 (C.S.I.R.O.) are utilised to some extent in conjunction with dairying activities.

Provision has been made in the lease documents for withdrawals necessary and there appears no practical objection to the proposal.

It is recommended that:

Appropriate action be taken for the withdrawal of the approximate areas shown in colour on plan M.S.431 attached for the purpose of development of the Botanical Gardens.

Resubmitted 18/10/1950 following approval of Botanic Gardens Area 16.10.1950. JEM

Surveyor General

18 OCT 1950

J.E. Morrow
(J.E. MORROW)
Senior Agricultural and
Lands Officer.
12/9/1950.

RS 17

APPROVED

J. H. Rogers

Delegate of the Minister of the Interior

19/10/50

M. Deuter for withdrawal notice 16.

COMMONWEALTH OF AUSTRALIA

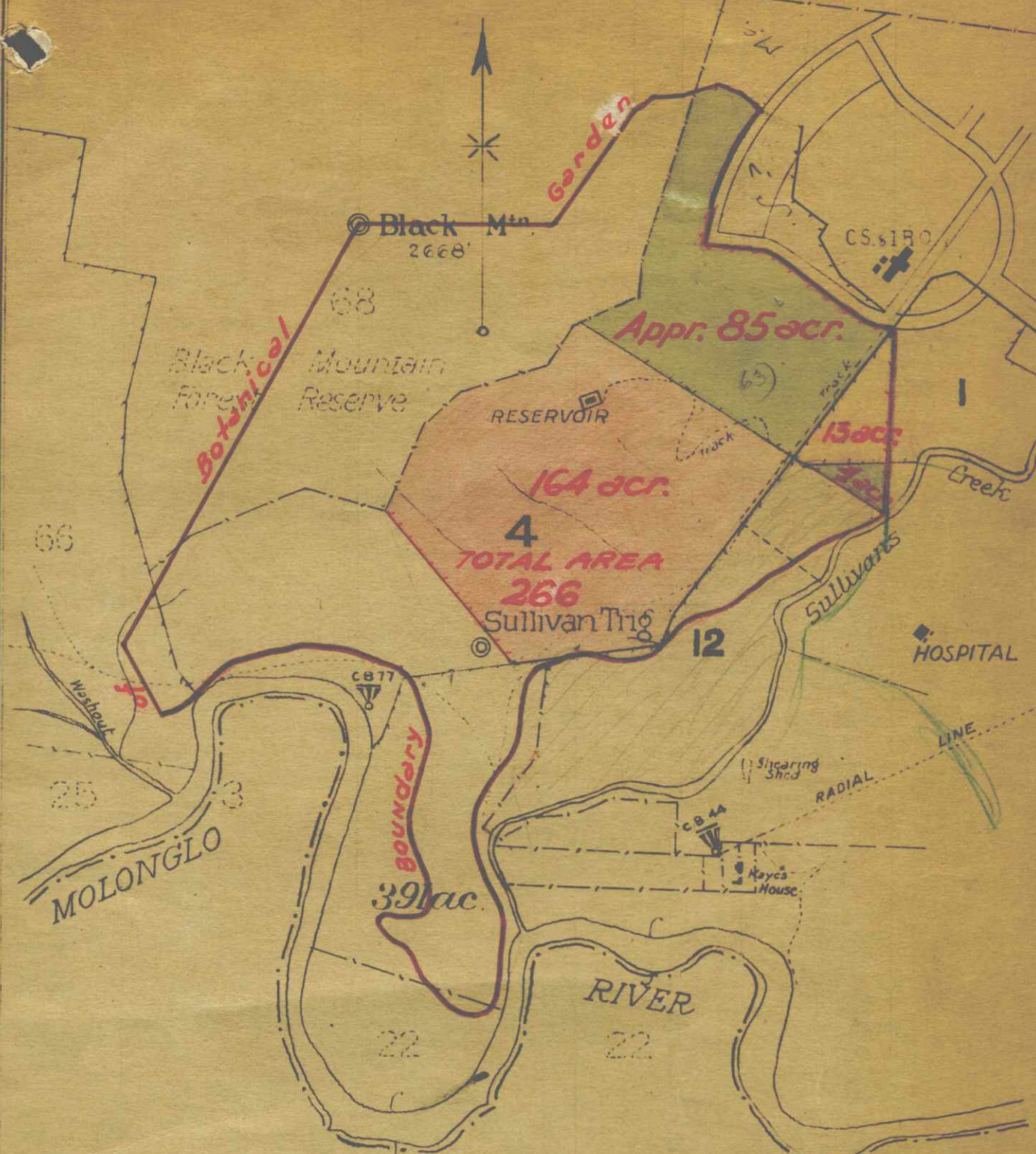

Note:

Existing fences shown in black (—)

(Reqd) New netting fences shown in red (—)

Bot Garden Boundaries
Lakes

area

Drawn by <i>E</i> Traced " Exam'd " <i>FAM</i>	Date <i>1.2.38</i> <i>22.38</i>	<h2>BLOCK 4^{PT} (12-1)</h2> <h3>CANBERRA CITY DISTRICT</h3> <h3>Federal Capital Territory</h3> Scale 20 Ch to an Inch	Surveyed by..... Date of Survey..... Azimuth..... Comput. Sheet..... F.B.....
			<h1>M^S431</h1>